

685 Fifth Avenue

685 Fifth Avenue, New York, NY

Northeast Corner of Fifth Avenue & E. 54th Street



HIGHLIGHTS

Type: Retail

Market: Fifth Avenue - Plaza District

TOTAL SF: 896SF

TOTAL FRONTAGE: 15' on Fifth Avenue

UNPARALLELED LOCATION

A rare opportunity presents itself at 685 Fifth Avenue. With the ease of having prime, central Manhattan location and the advantage of being so closely located to the most elite retailers, 685 Fifth Avenue is truly a gem. With the most internationally recognized luxury retailers, global brands, offices and hotels, Fifth Avenue caters to the masses of New York and international clientele.

PEDESTRIANS GALORE

Over 50 million tourists visit this luxurious retail corridor in the Plaza District along Fifth Avenue bolstering over \$4 billion in annual sales. 685 Fifth Avenue is steps away from many of Manhattan's top performing retail stores and tourist destinations, including Rockefeller Center attracting 330,000 pedestrians daily.

HIGHEST PERFORMANCE RETAIL

The biggest names in fashion are housed along Fifth Avenue. With glistening storefronts and some of the world's most coveted couture, Fifth Avenue is the epitome of New York luxury and style. Fifth Avenue is globally recognized as the #1 shopping street in the world. An unrivaled shopping destination, Fifth Avenue offers all the elite names in retail. From the exquisite clothing in stores, to the central location neighboring Rockefeller Center and other impressive destinations, 685 Fifth Avenue is extremely well situated. Neighboring retailers include Fendi, Salvatore Ferragamo, Valentino, Zara, Bergdorf Goodman, Prada, Cartier, Gucci and many more. Visibility is at its utmost at the corner of Fifth and 54th street.

DYNAMIC LAYOUT

This premier, multi-level retail space boasts 23,858 SF across 4 levels. With approximately 59' of frontage dedicated along Fifth Avenue, this property at the southeast corner of 54th Street and Fifth Avenue is poised for success in the luxurious Plaza District.

685 Fifth Avenue

685 Fifth Avenue, New York, NY

Northeast Corner of Fifth Avenue & E. 54th Street



CONCEPTUAL
STREET LEVEL FLOOR PLAN

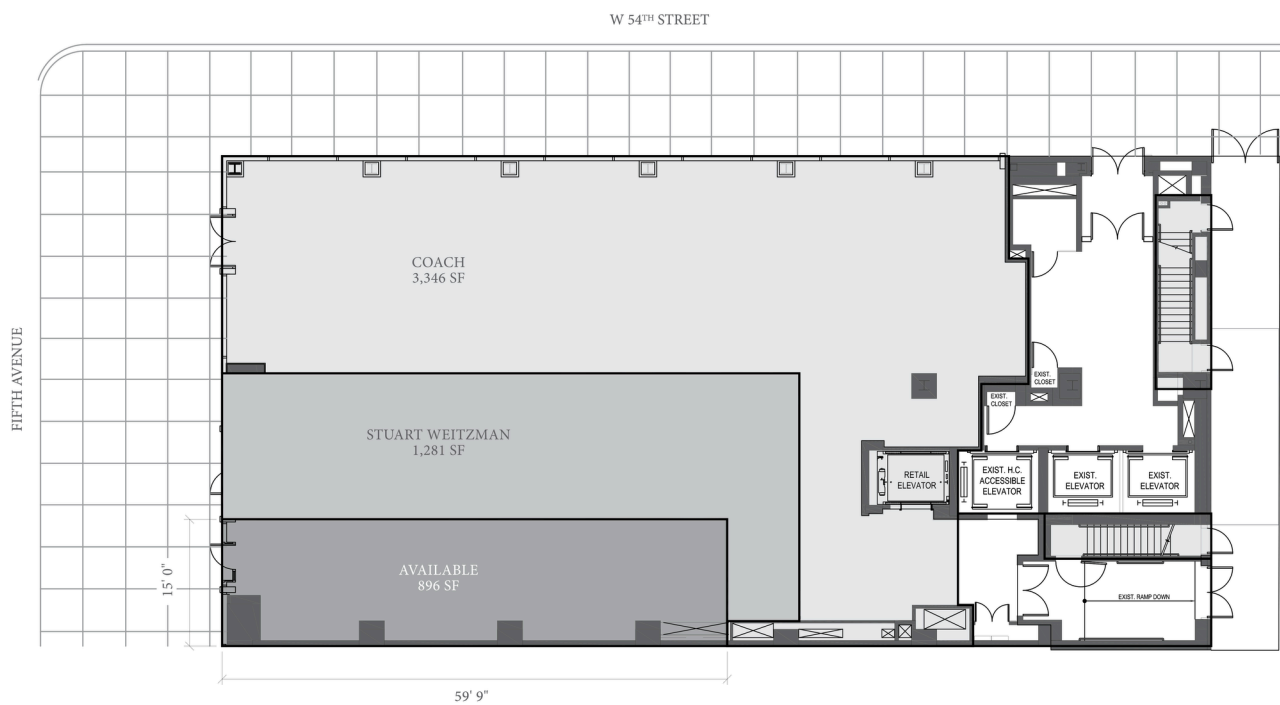

* Plans are conceptual. Building square footage will need additional verification.

Ground Floor Available 896 SF