

# 93 N. 9th Street

93 N. 9th Street, Brooklyn, NY 11249

North Block between Wythe Avenue & Berry Street



## HIGHLIGHTS

For Lease  
Type: Retail  
Total SF: 12,000  
Market: Brooklyn - Williamsburg

## CONTACT

Sam Sabin  
212-529-7413  
ssabin@thorequities.com

TOTAL SF: 12,000  
GROUND: 12,000 SF

FRONTAGE:  
100'

### UNPARALLELED LOCATION

In Brooklyn's charming Williamsburg, 93 N. 9th St. is a flagship retail gem. The revamping of Brooklyn's trendy new neighborhoods has been gradual, but Williamsburg has always stood out as one of the "places to be" in New York City. Steps away from the bustling East River State Park, home of Brooklyn Flea and Smorgasburg, this property offers accessibility and visibility with that classic, Brooklyn warehouse feel and incredible flagship potential.

### HEAVILY TRAFFICKED SHOPPING DISTRICT

The Hoxton Hotel, to be built on Wythe Avenue and adjacent to the property, will open in early 2017 with 180 rooms, two bars and a restaurant. 93 N. 9th is steps from the Bedford Avenue L train, which carries 9.2 million riders annually and has the potential to increase retail value exponentially in the next two years. Prominent retailers continue to establish themselves in Williamsburg to keep up with young and trendy residents, who are prevalent in this neighborhood and the rest of Brooklyn. Williamsburg also attracts young families with an eye for style choosing to live in loft/warehouse like apartments on the water, and continues to be home to numerous beloved cafes and shops. This mixture of redevelopment and tradition makes Williamsburg truly special.

### EXCELLENT RETAIL OPPORTUNITY

93 N. 9th St. offers one level with 12,000 SF in total, and 100 feet of frontage. It is the classic Brooklyn warehouse with an open layout plan. This property is perfect for retailers to showcase in one of the strongest retail markets in Brooklyn, within steps of the L train.

# 93 N. 9th Street

93 N. 9th Street, Brooklyn, NY 11249

North Block between Wythe Avenue & Berry Street

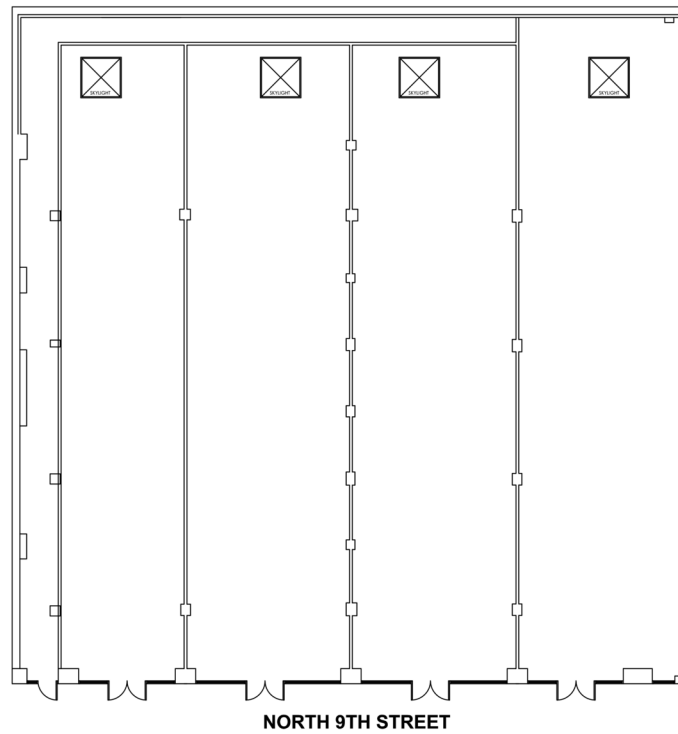

## GROUND FLOOR PLAN

SCALE: NTS



25 WEST 39TH STREET  
NEW YORK, N.Y. 10018  
TEL 212 529-5055

THIS EXHIBIT IS PROVIDED FOR ILLUSTRATIVE PURPOSES ONLY, AND SHALL NOT BE DEEMED TO BE A WARRANTY, REPRESENTATION OR AGREEMENT BY LANDLORD THAT THE CENTER, COMMON AREAS, BUILDINGS AND/OR EXHIBIT WILL BE AS ILLUSTRATED ON THIS EXHIBIT, OR THAT ANY TENANTS, WHICH MAY BE REFERENCED ON THIS EXHIBIT, WILL AT ANY TIME BE OCCUPANTS OF THE CENTER. LANDLORD RESERVES THE RIGHT TO MODIFY SIZE, CONFIGURATION AND OCCUPANTS OF THE CENTER AT ANY TIME.

93 N. 9TH STREET  
BROOKLYN, NY  
DATE: 2015-02-11  
DRAWN BY: MCP

EX

Q:\93 N 9th Street\CAD\2015-02-11\_93 North 9th St Exhibit.dwg, 2/12/2015 12:07:22 PM, Adobe PDF

Ground Floor Available 12,000 SF