

60 EAST 66TH STREET

NEW YORK, NY

UPPER EAST SIDE

- Between Park Avenue and Madison Avenue
- Approximately 7,500sf
- 2 spaces available
- Space 4B: 650sf
- Space 5A: 600sf

HIGHLIGHTS

DYNAMIC LAYOUT

60 East 66th Street is located just steps away from Central Park and Fifth Avenue to the West, and the world famous Madison Avenue shopping district to the East. The property offers approximately 7,500sf in total, and offers two retail/commercial spaces measuring approximately 650sf and 600sf. With tall ceilings, a garden backyard, and multiple terraces, this townhouse building holds limitless potential presenting a rare and unmatched opportunity.

NEIGHBORHOOD ANALYSIS

The Upper East Side is home to a plethora of museums that comprise Museum Mile: the grand Metropolitan, the spiral Guggenheim, the innovative Whitney, the quietly elegant Neue Galerie, and the vast mansions-turned-museums, such as the Frick and the Cooper-Hewitt, mean this area has the greatest concentration of artistic treasures anywhere on earth. Additionally, almost every major retailer has a location in the prestigious neighborhood where some of Manhattan's most affluent continuously stroll the streets and peruse the stores.



WHY THIS LOCATION ?

NEIGHBORHOOD DESCRIPTION

60 East 66th Street is located in the Upper East Side Historic District, designated in 1981 as one of Manhattan's largest landmark districts. Stretching along Fifth Avenue from 59th to 78th Streets, this area is universally known as one of the most prestigious and sought-after neighborhoods in the world. Today, the district boasts an impressive array of properties ranging from iconic brownstone row houses to elegant townhomes and apartment towers. With Madison Avenue and Park Avenue shopping, 60 East 66th Street is poised in the heart of a neighborhood whose residents are well known to frequent retailers as well as the endless tourists who make this neighborhood a stop on their retail destinations.

25 West 39th Street
New York, NY 10018
Phone (212) 529-5055
FAX (212) 460-5362
THOREQUITIES.COM



THOR
EQUITIES

60 EAST 66TH STREET

NEW YORK, NY

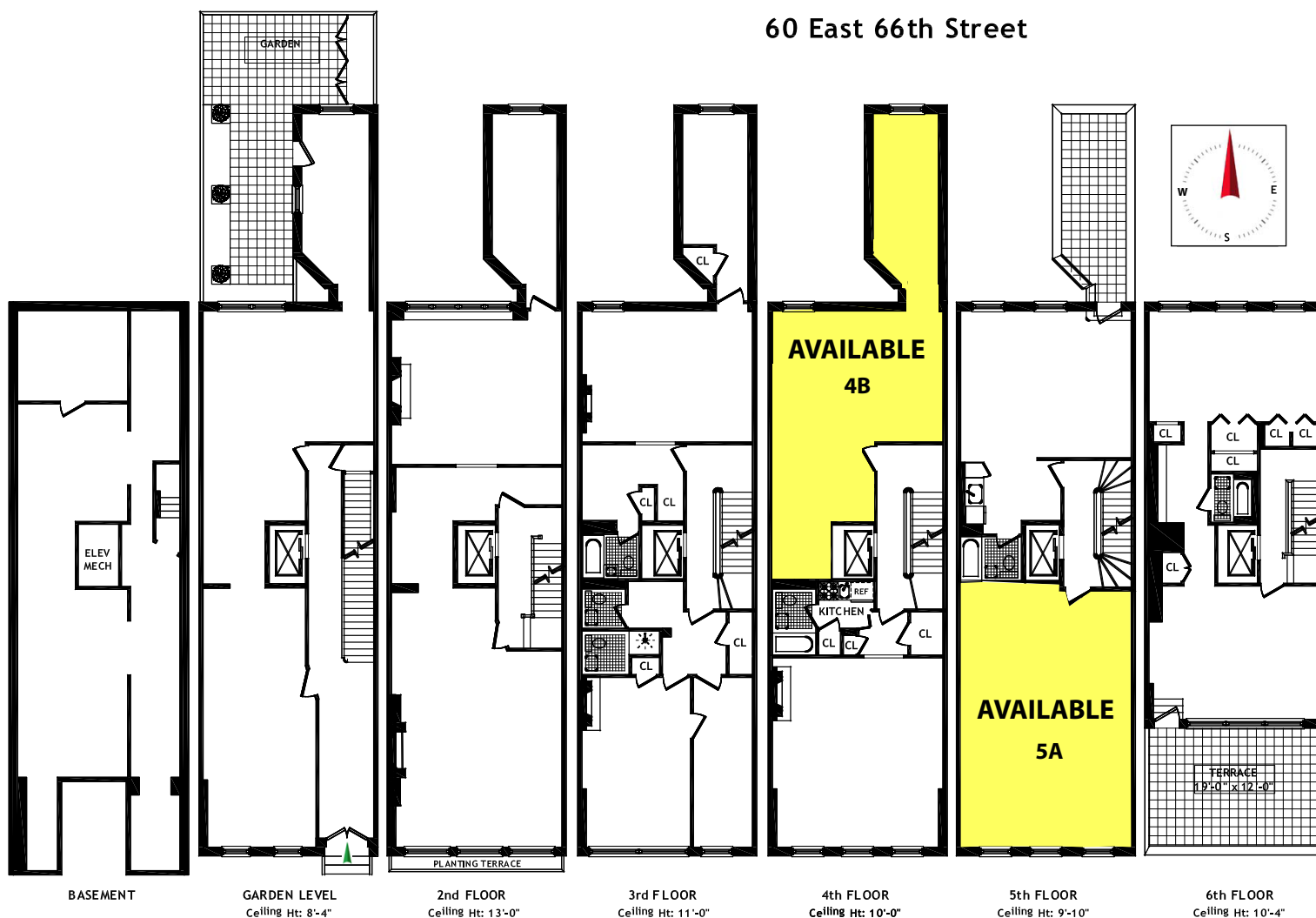

CONTACT:

JORDAN CLAFFEY
VICE PRESIDENT OF LEASING
25 WEST 39TH STREET
NEW YORK, NY 10018
(212) 529-7412
JCLAFFEY@THOREQUITIES.COM
WWW.THOREQUITIES.COM